



**DYNAMIC OUT OF WALL FIRE DAMPER  
GRILLE MOUNT WITH DAMPER ACCESS  
FOR DYNAMIC OR STATIC SYSTEMS  
1 1/2 HR. LABEL • AIRFOIL BLADE  
MODEL: D1201-OW**



**QUALIFICATIONS:**

- **UL 555 CLASSIFIED DYNAMIC FIRE DAMPER • 1 1/2 hr. Label (File #R9492).**
- **CAN/ULC-S112 CLASSIFIED FIRE DAMPER (File #R19569).**
- **Meets NFPA 80, 90A and 101 as well as IBC and NBC (Canada) Building Code requirements.**
- **Maximum velocity 3000 fpm @ 4" w.g.**
- **For use in vertical or horizontal concrete partitions and vertical steel stud partitions only.**

The Model D1201-OW is an "out of wall" high performance fire damper. It is specifically designed for supply or return ducts that terminate at a grille and provides through the grille access to the damper. Standard sleeve length accommodates most commercial supply and return grilles/registers.

The D1201-OW is ideal for applications where building codes require a fire damper for the protection of ductwork penetrations in walls or floors that have a fire resistance rating of up to 2 hours.

The D1201-OW offers premium performance and a low pressure drop well suited to the majority of commercial applications. Unique, inter-locking double skin blade design eliminates combustible seals and provides flame protection under fire conditions at temperatures up to 2000°F.

The D1201-OW is supplied as standard with an internal locking quadrant which holds the damper in the fully open position, but may also be used for system balancing if required.

**STANDARD SPECIFICATION:**

**Frame:** 5" x 7/8" x 16 ga. (127 x 22 x 1.6) galvanized steel hat channel.

**Blades:** 14 ga. (2.0) equivalent galvanized steel formed airfoil on 5 1/2" (140) centers. Opposed action.

**Sleeve:** 16" x 20 ga. (406 x 1.0) galvanized steel with 3/4" (19) flange on one end standard.

**Insulation:** Intumescent thermal insulation on four sides.

**Linkage:** Concealed in frame. 12 ga. (2.7) plated steel.

**Bearings:** 1/2" (13) dia. self-lubricating oilite bronze.

**Axles:** 1/2" (13) dia. plated steel double bolted to blades.

**Jackshaft:** 1/2" (13) dia. cadmium plated steel.  
Internal locking quadrant is factory installed.

**Fusible Link:** 165°F (74°C) standard.  
212°F (100°C) available.

**Minimum Size:** Vertical or Horizontal mount: 8" W x 8" H (203 x 203).

**Maximum Size:** Single Section  
Vertical mount: 36" W x 48" H (914 x 1219).  
Horizontal mount: 32" W x 48" H (813 x 1219).  
Multiple Section Assemblies are not permitted.

**BASE MODEL SELECTION:**

- D1201-OW** Standard factory sleeve. See above.
- D1201-OW** Non-standard sleeve.  
Specify \_\_\_\_\_ length \_\_\_\_\_ ga.  
A custom length sleeve can be furnished when an other than standard grille depth clearance is required.

**OPTIONS:**

- BS** Stainless steel bearings
- MLS-300** Position indicator switch pack
- JSM** Flexible metal jamb seals
- QS1** Quick-set retaining angle (one side)
- TDF1** TDF Flange (one end)

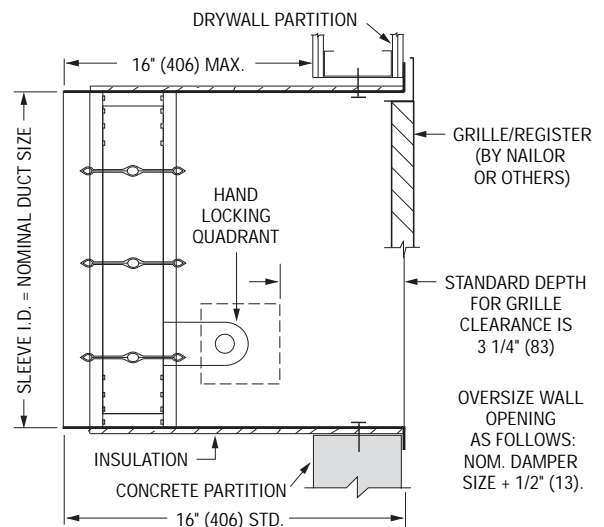
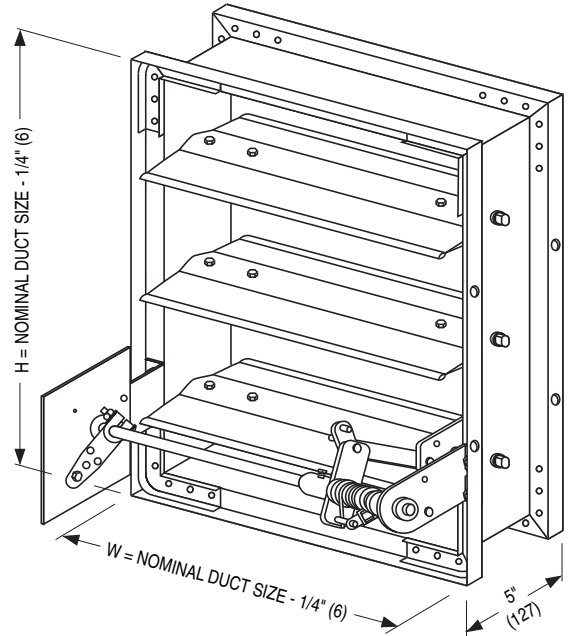

For installation instructions, see IOM-D1201OWINST.

|                                |             |                 |                   |                    |
|--------------------------------|-------------|-----------------|-------------------|--------------------|
| <b>SCHEDULE TYPE:</b>          |             |                 |                   |                    |
| <b>PROJECT:</b>                |             |                 |                   |                    |
| Dimensions are in inches (mm). |             |                 |                   |                    |
| <b>ENGINEER:</b>               | <b>DATE</b> | <b>B SERIES</b> | <b>SUPERSEDES</b> | <b>DRAWING NO.</b> |
| <b>CONTRACTOR:</b>             | 1 - 1 - 12  | D1200           | 12 - 2 - 09       | D1201-OW           |